

# Leopard V1 800

## Service Over the Counter

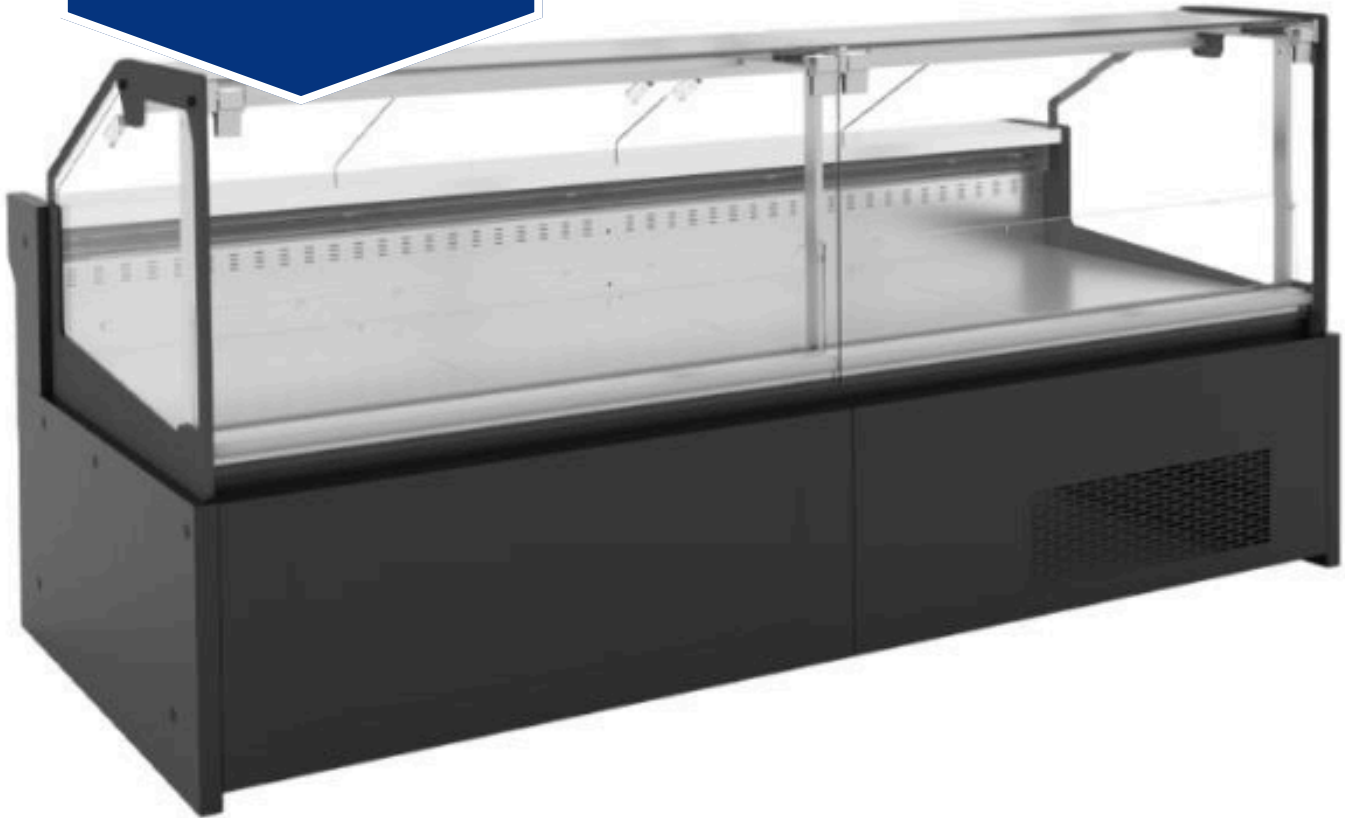

### Technical Specifications

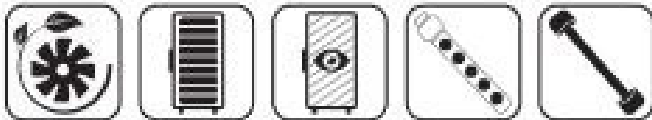

### Categories / Kategoriler



- Dairy Products
- Meat & Fish

### Available Modules

	937	1250	1875	2500
Length (mm)	937	1250	1875	2500
Side panel (mm)	40	40	40	40

### Operating Temperatures

### Ambient Conditions

M1 (-1/+5°C) - M2 (-1/+7°C)	25°C / 60% RH (EN ISO 23953-2)
-----------------------------	--------------------------------

**Plug-in Unit  
Over the Counter  
Service**

**Leopard V1 800**  
Service Over the  
Counter

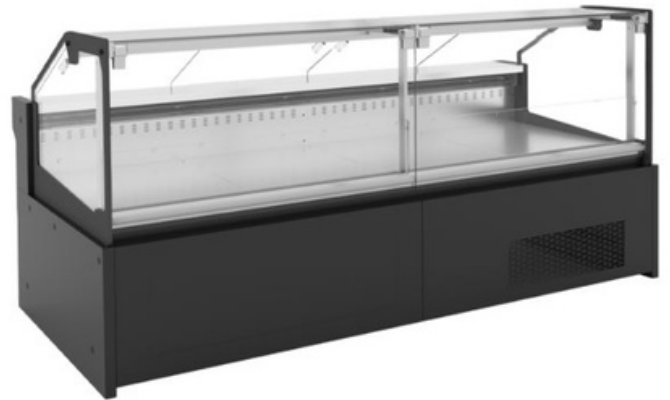
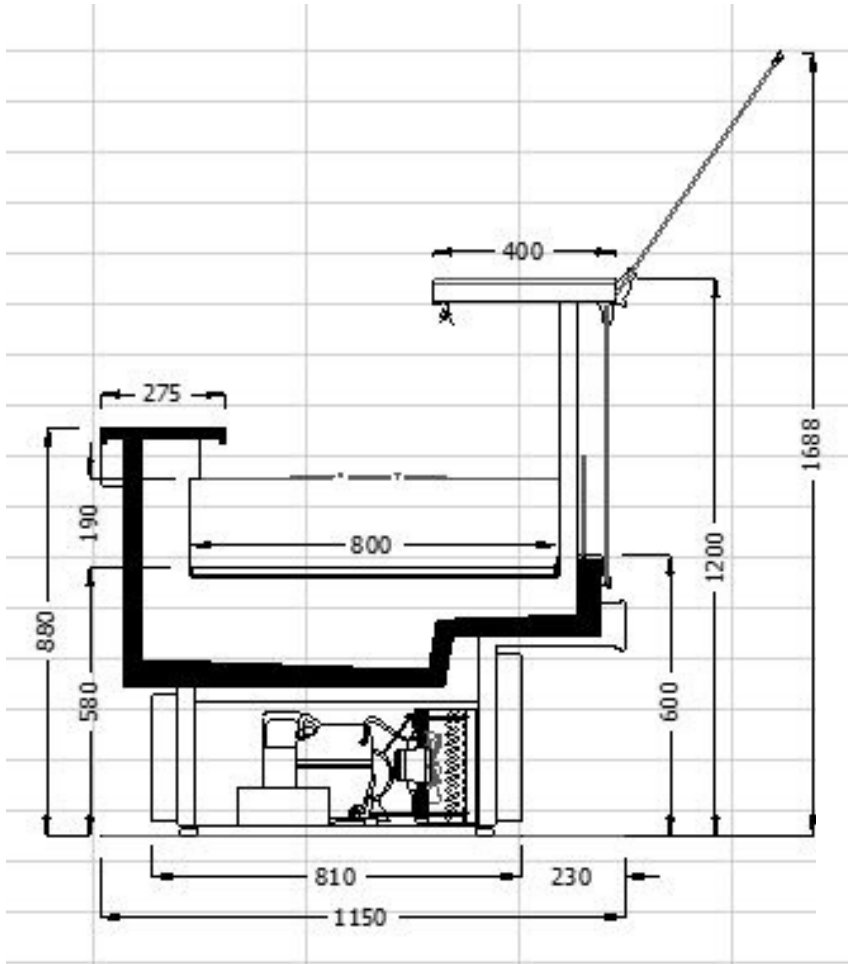

**Ask us about extending the Product area**

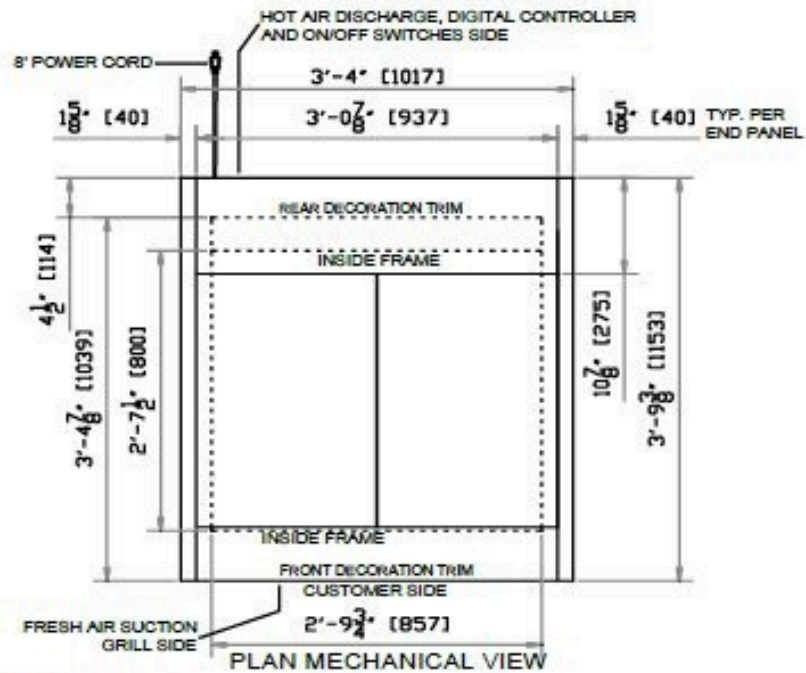

LEOPARD 800 FG/CB L:937

QTY	DESCRIPTION	PART NUMBER	VOLTAGE	PHASE	AMPS	TOTAL AMPS
1	CANOPY LIGHTINGS	HORIZONTAL, L-830, UL	24	1	0,38	0,38
1	EVAPORATOR COIL FAN MOTOR	EC AXIAL UL-Ex	115	1	0,20	0,20
1	COMPRESSOR	HERMETIC, R290A, EM2X3134U	115	1	2,97	2,97
1	CONDENSER COIL FAN MOTOR	EC AXIAL UL-Ex	115	1	0,20	0,20
1	ANTIFOG GLASS FAN MOTOR	12"X12 SQUARE UL-Ex	115	1	0,08	0,08
1	DEFROST HEATER (OPTIONAL)	TUBULAR HETAERS, UL	115	1	1,74	1,74
1	ANTIFOG GLASS HEATER (OPTIONAL)	TUBULAR HETAERS, UL	115	1	1,74	1,74
1	CONDENSATE TRAY HEATER (OPTIONAL)	WITH PTC SENSOR, UL	115	1	3,48	3,48

CIRCUIT#1

TOTAL AMPS : 10,79

VOLTAGE : 115/1/60

CONNECTION : NEMA 5-15

MODEL: LEOPARD 800 FG/CB L:937

APPLICATION : Deli, Fresh Meat & Poultry

BTUH : 2637,5

EVAP TEMP :

DEFROST: TIME-OFF, 4/45MIN, 30°F TEMP TERMINATION

\* OPTIONAL COMPONENT LOAD INCLUDED

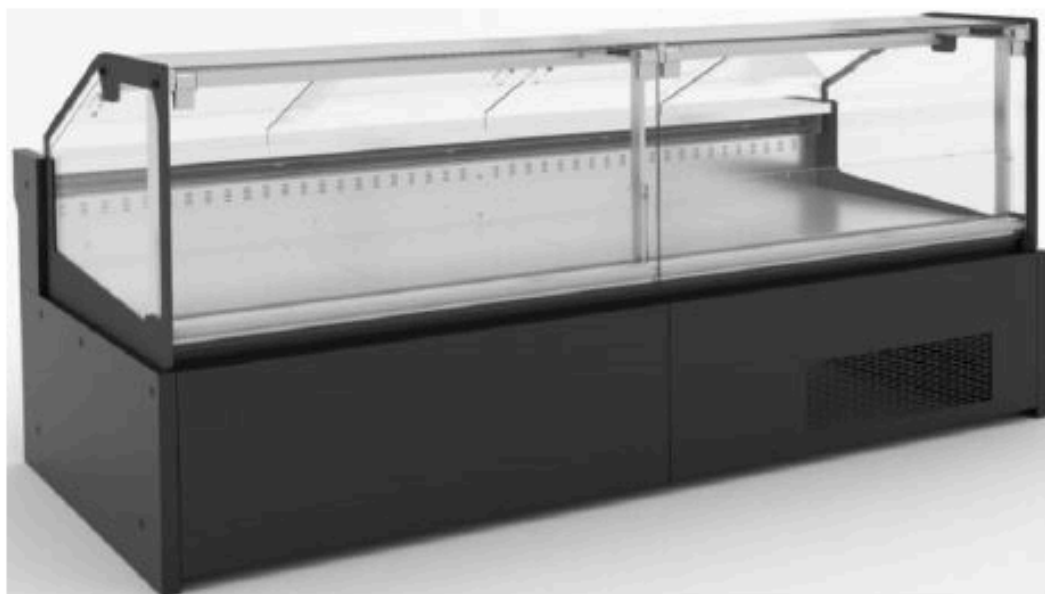

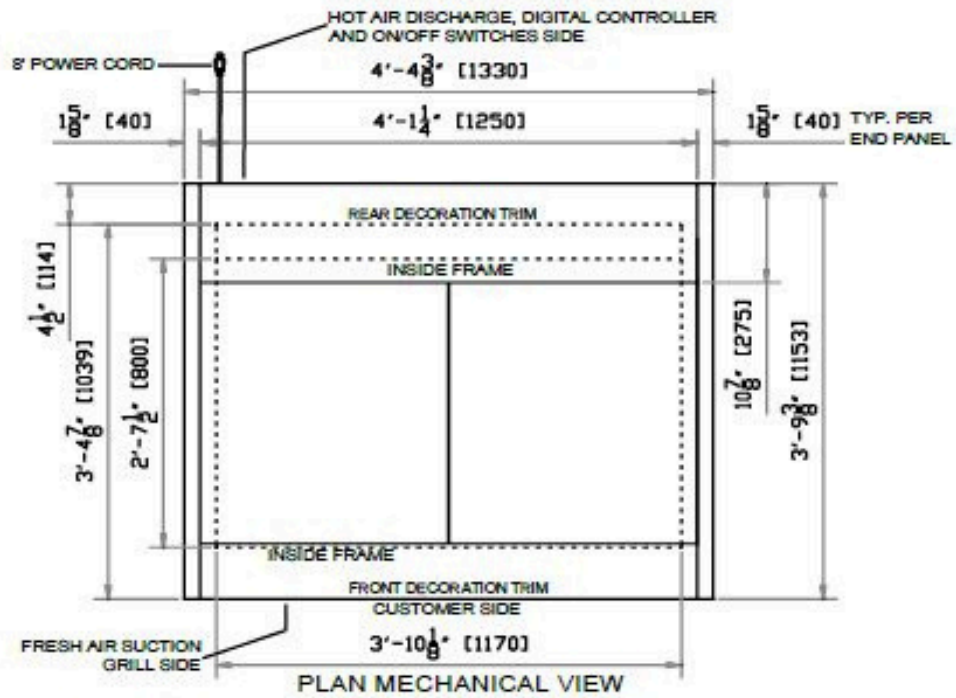

LEOPARD 800 FG/CB L:1250

QTY	DESCRIPTION	PART NUMBER	VOLTAGE	PHASE	AMPS	TOTAL AMPS
1	CANDOPY LIGHTINGS	HORIZONTAL, L:1150, UL	24	1	0,50	0,50
1	EVAPORATOR COIL FAN MOTOR	EC AXIAL UL-Ex	115	1	0,20	0,20
1	COMPRESSOR	HERMETIC, R290A, EMC3134U	115	1	2,84	2,84
1	CONDENSER COIL FAN MOTOR	EC AXIAL UL-Ex	115	1	0,20	0,20
1	ANTIFOG GLASS FAN MOTOR	12"X12 SQUARE UL-Ex	115	1	0,08	0,08
1	DEFROST HEATER (OPTIONAL)	TUBULAR HETAERS, UL	115	1	2,17	2,17
1	ANTIFOG GLASS HEATER (OPTIONAL)	TUBULAR HETAERS, UL	115	1	2,17	2,17
1	CONDENSATE TRAY HEATER (OPTIONAL)	WITH PTC SENSOR, UL	115	1	3,48	3,48

CIRCUIT#1 TOTAL AMPS : 11,65 VOLTAGE : 115/1/60 CONNECTION : NEMA 5-15  
 MODEL: LEOPARD 800 FG/CB L:1250 APPLICATION : Deli, Fresh Meat & Poultry BTUH : 2907 EVAP TEMP :  
 DEFROST: TIME-OFF, 4/43MIN, 30°F TEMP TERMINATION

\* OPTIONAL COMPONENT LOAD INCLUDED

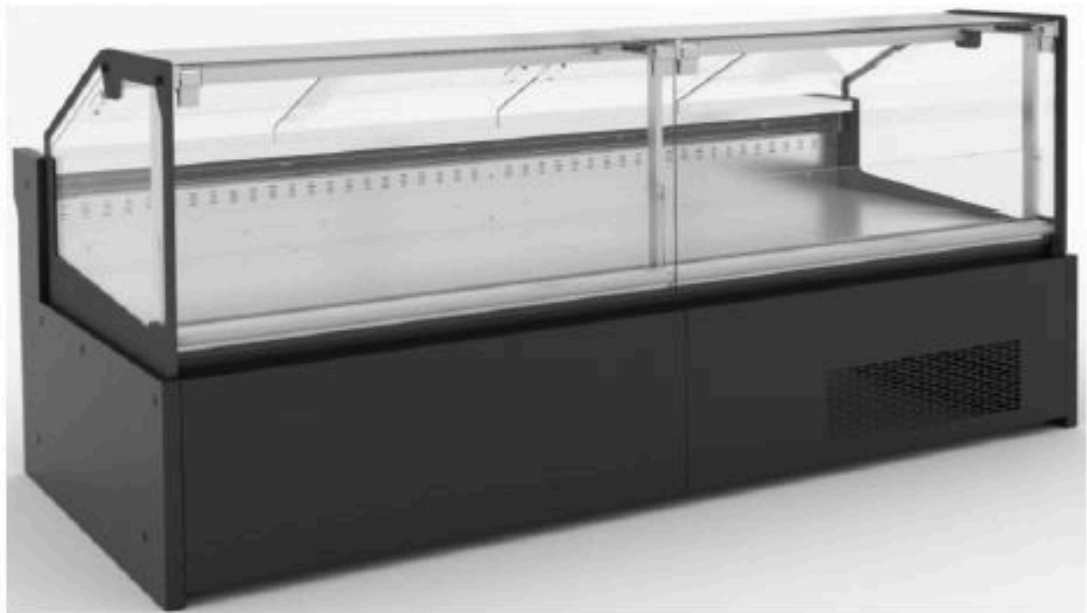

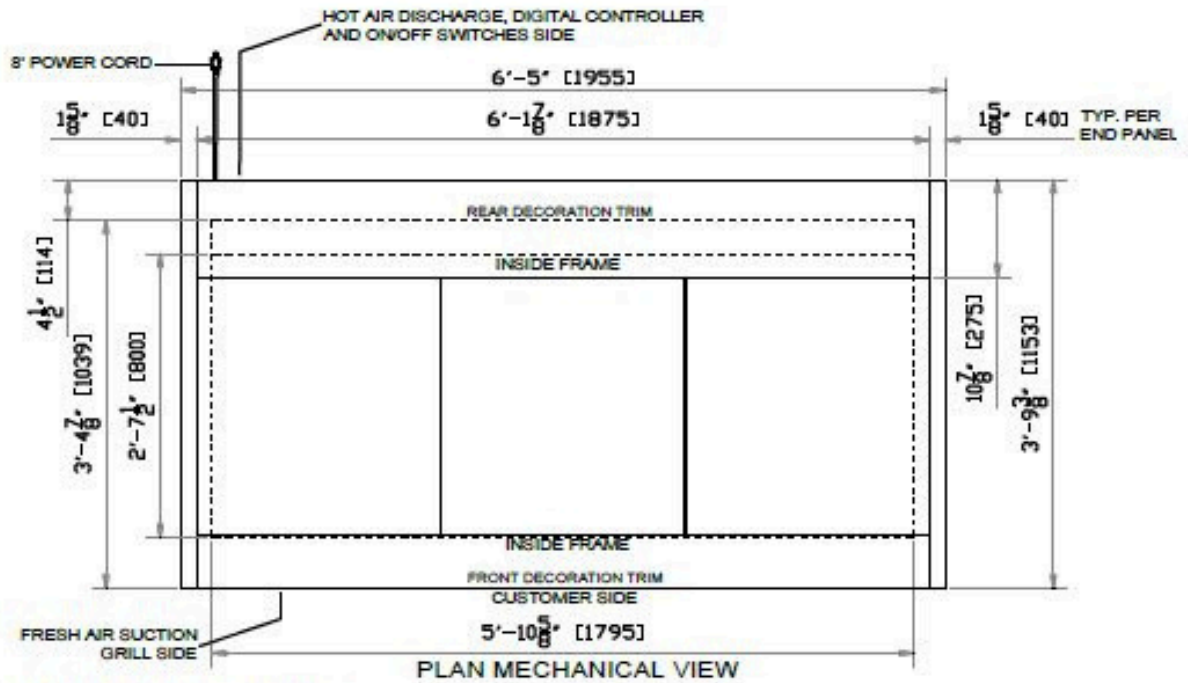

**LEOPARD 800 FG/CB L:1875**

QTY	DESCRIPTION	PART NUMBER	VOLTAGE	PHASE	AMPS	TOTAL AMPS
2	CANDOPY LIGHTINGS	HORIZONTAL, L:850, UL	24	1	0,75	0,75
2	EVAPORATOR COIL FAN MOTOR	EC AXIAL UL-Ex	115	1	0,40	0,40
1	COMPRESSOR	HERMETIC, R290A, EMC3145U	115	1	4,22	4,22
1	CONDENSER COIL FAN MOTOR	EC AXIAL UL-Ex	115	1	0,20	0,20
2	ANTIFOG GLASS FAN MOTOR	12"12 SQUARE UL-Ex	115	1	0,16	0,16
1	DEFROST HEATER (OPTIONAL)	TUBULAR HETAERS, UL	115	1	3,48	3,48
1	ANTIFOG GLASS HEATER (OPTIONAL)	TUBULAR HETAERS, UL	115	1	3,48	3,48
1	CONDENSATE TRAY HEATER (OPTIONAL)	WITH PTC SENSOR, UL	115	1	6,09	6,09

CIRCUIT#1 TOTAL AMPS : 18,77 VOLTAGE : 115/1/60 CONNECTION : NEMA 5-20  
 MODEL: LEOPARD 800 FG/CB L:1875 APPLICATION : Deli, Fresh Meat & Poultry BTUH : 3634 EVAP TEMP :  
 DEFROST: TIME-OFF, 4/43MIN, 50°F TEMP TERMINATION

\* OPTIONAL COMPONENT LOAD INCLUDED

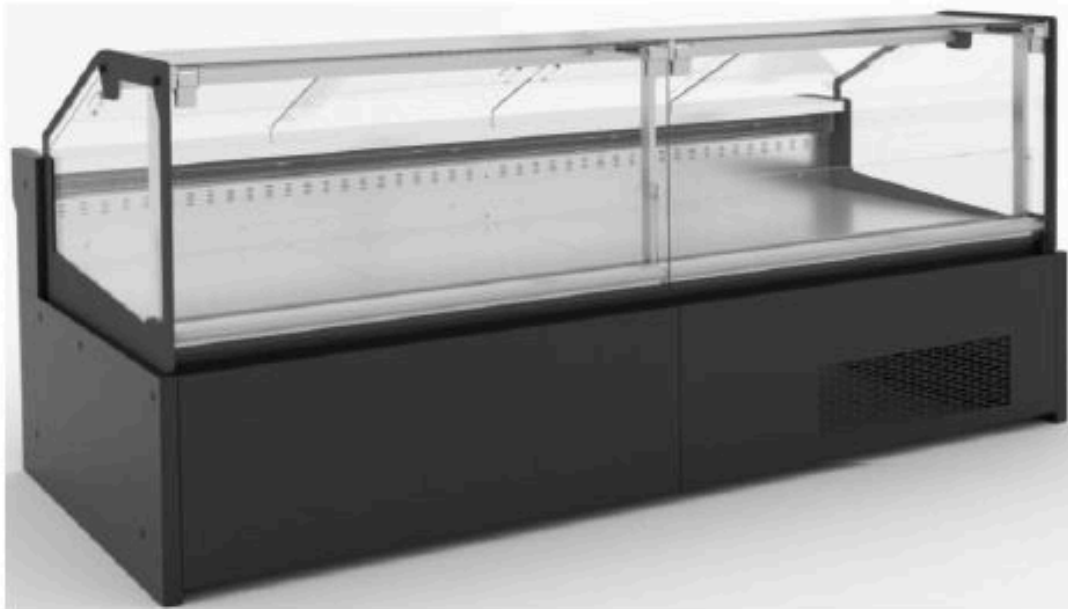

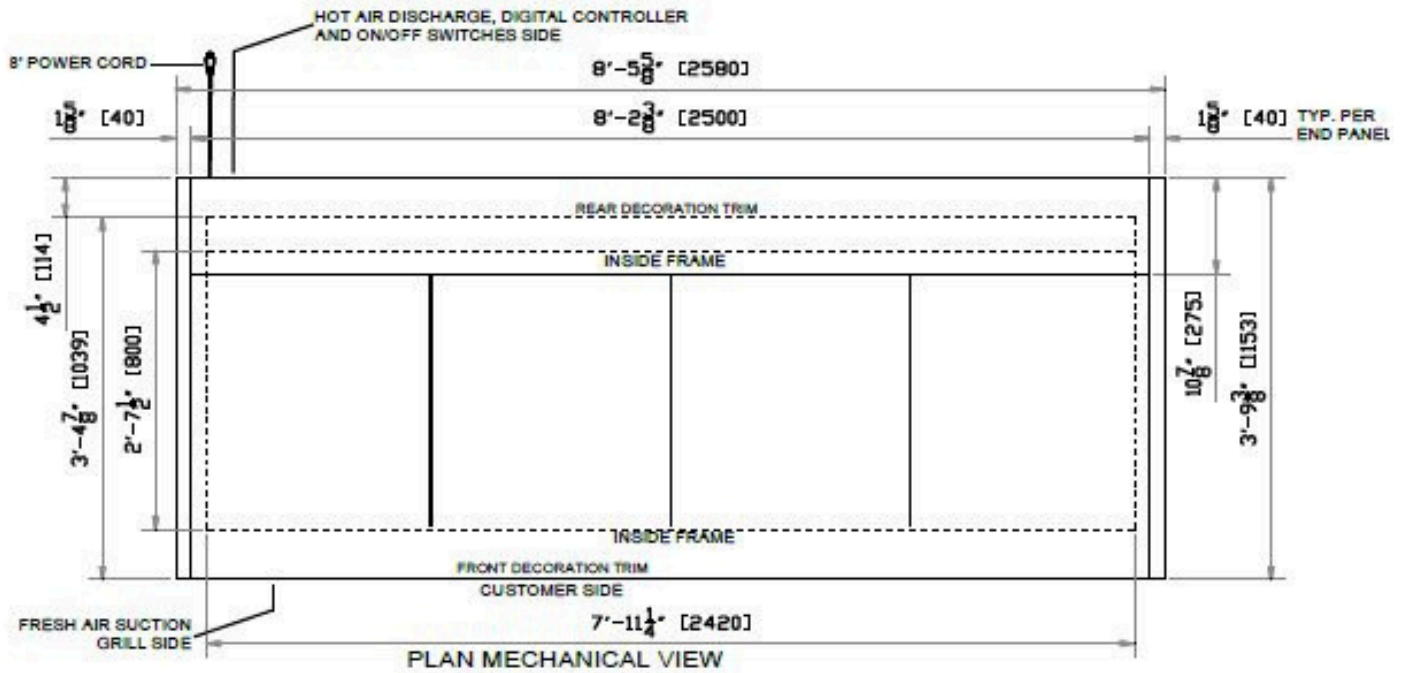

**LEOPARD V1 800 FG/CB L:2500**

QTY	DESCRIPTION	PART NUMBER	VOLTAGE	PHASE	AMPS	TOTAL AMPS
2	CANOPY LIGHTINGS	HORIZONTAL, L:1150, UL	24	1	1,00	1,00
2	EVAPORATOR COIL FAN MOTOR	EC AXIAL UL-Ex	115	1	0,40	0,40
2	COMPRESSOR	HERMETIC, R290A, EM2X3134U	115	1	3,95	3,95
2	CONDENSER COIL FAN MOTOR	EC AXIAL UL-Ex	115	1	0,40	0,40
2	ANTIFOG GLASS FAN MOTOR	12"12 SQUARE UL-Ex	115	1	0,16	0,16
1	DEFROST HEATER (OPTIONAL)	TUBULAR HETAERS, UL	115	1	3,22	3,22
1	ANTIFOG GLASS HEATER (OPTIONAL)	TUBULAR HETAERS, UL	115	1	3,22	3,22
1	CONDENSATE TRAY HEATER (OPTIONAL)	WITH PTC SENSOR, UL	115	1	6,09	6,09

CIRCUIT#1 TOTAL AMPS : 24,43 VOLTAGE : 115/1/60 CONNECTION : NEMA 5-30  
 MODEL: LEOPARD V1 800 FG/CB L:2500 APPLICATION : Deli, Fresh Meat & Poultry BTUH : 5274,95 EVAP TEMP :  
 DEFROST: TIME-OFF, 4/45MIN, 30°F TEMP TERMINATION

\* OPTIONAL COMPONENT LOAD INCLUDED

